

## Pulse Climbing Adamstown - Ground floor Plan

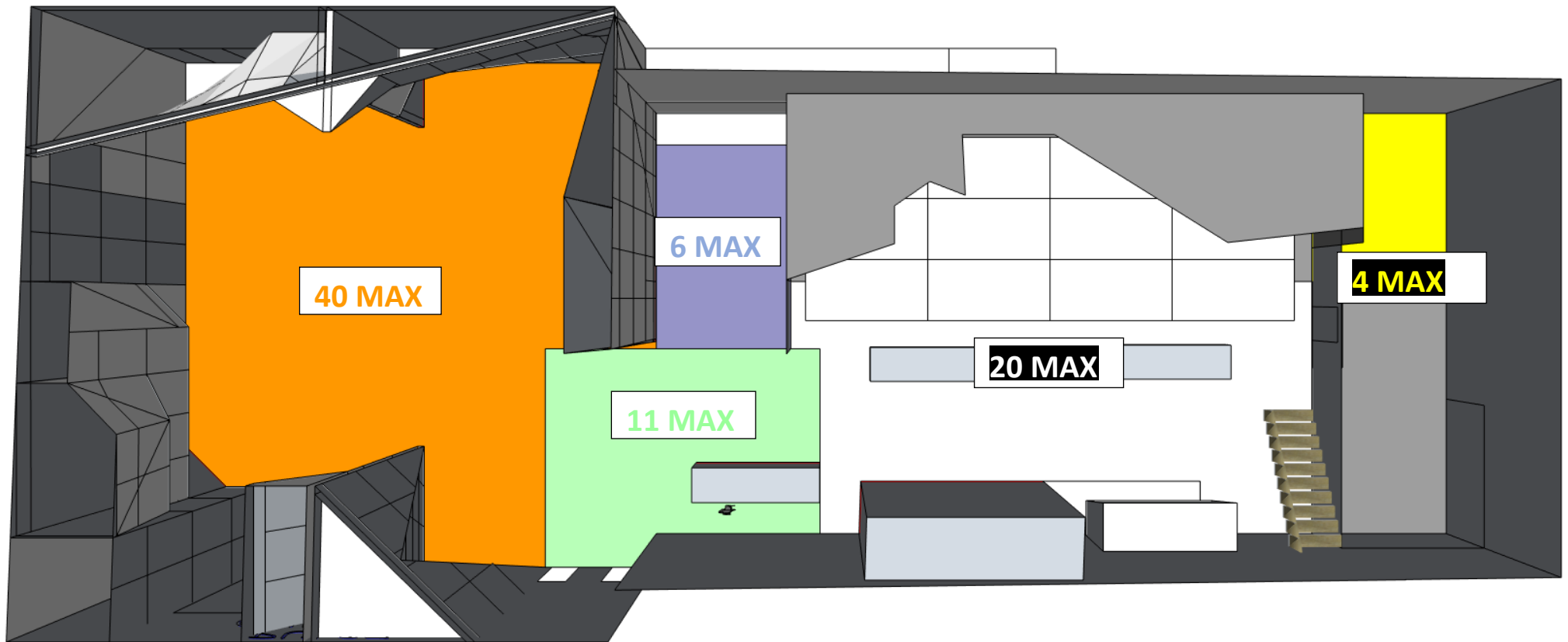

**1. Main Climbing Room 160M/2 – 40 person maximum**

**2. Entry and counter 44M/2 – 11 person maximum**

**3. Shop 24M/2 – 6 person maximum**

**4. Main Boulder room and beginner wall 140M/2 – 20 Person maximum**

**5. Party Room 20M/2 – 4 Person maximum**

## Pulse Climbing Adamstown - First floor Plan

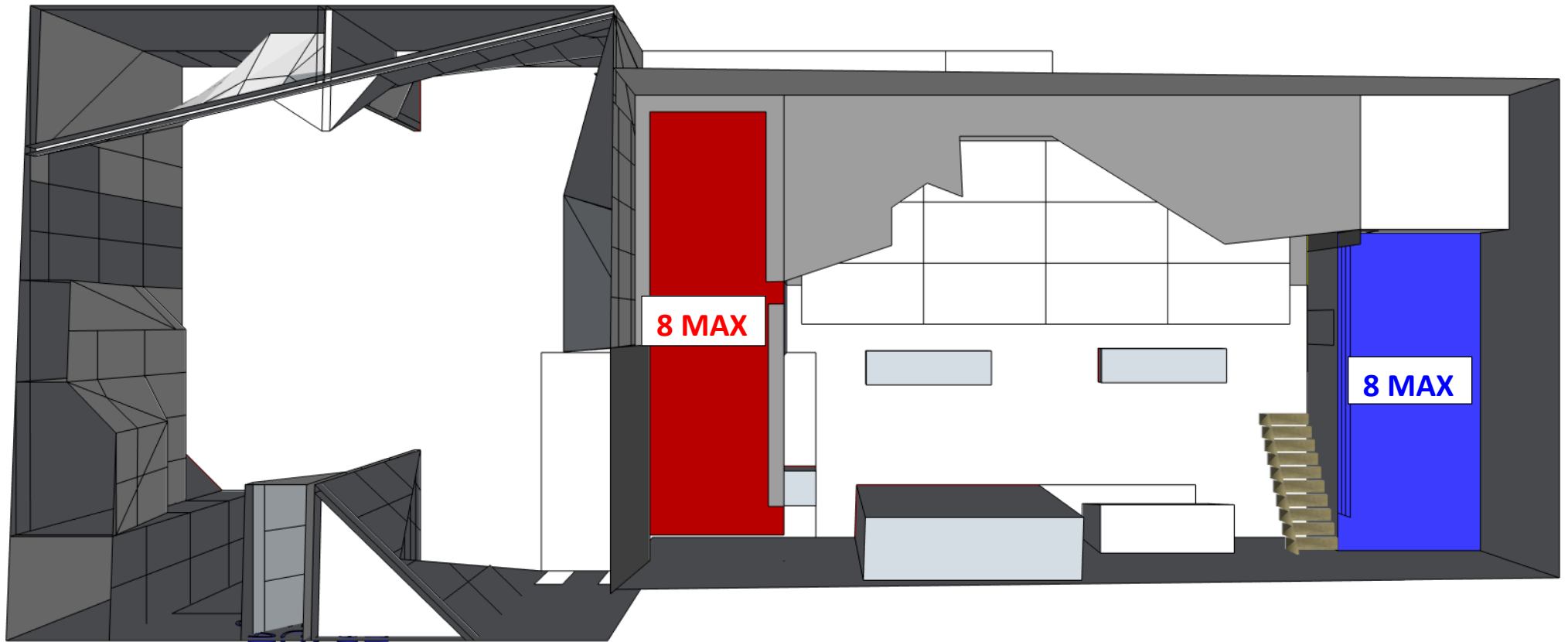

1. Boulder Loft 32M/2 – 8 people maximum

2. Upstairs training area 35M/2 – 8 people maximum